



CONTECH MOTORCYCLES

Kawasaki KLX 300

QUICK ASSEMBLY GUIDE | CRASH BARS

FOR FULL INSTALLATION INSTRUCTIONS, PLEASE WATCH [THIS VIDEO](#).

Tools Required

- ☐ 17mm Wrench/Spanner
- ☐ Ratchet + Extension
- ☐ 5mm Allen Socket
- ☐ 6mm Allen Socket
- ☐ 8mm Hex Socket
- ☐ 17mm Hex Socket
- ☐ Blue Loctite (recommended)

Number	QTY	Specifications	Torque (NM)
<u>1</u>	2	M10 x 110mm Hex Bolt	*
<u>2</u>	4	M8 x 20mm Allen Bolt	23
<u>3</u>	2	M6 x 16mm Allen Bolt	10
<u>4</u>	4	M10 Washer	-
<u>5</u>	2	M10 Nyloc Nut	-
<u>6</u>	4	M8 Washer	-
<u>7</u>	2	M6 Washer	-

* PLEASE REFER TO THE OWNER'S (OR SERVICE) MANUAL FOR OEM TORQUE SPECIFICATIONS.*

STEP 1:

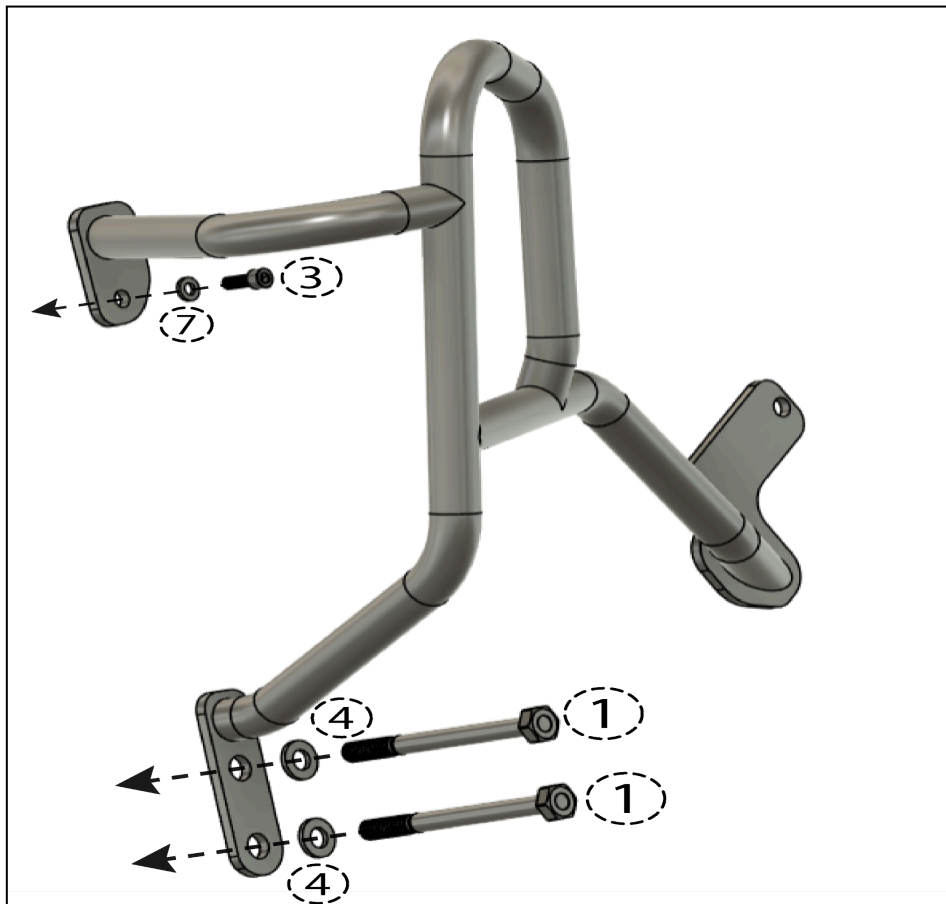

STEP 2:

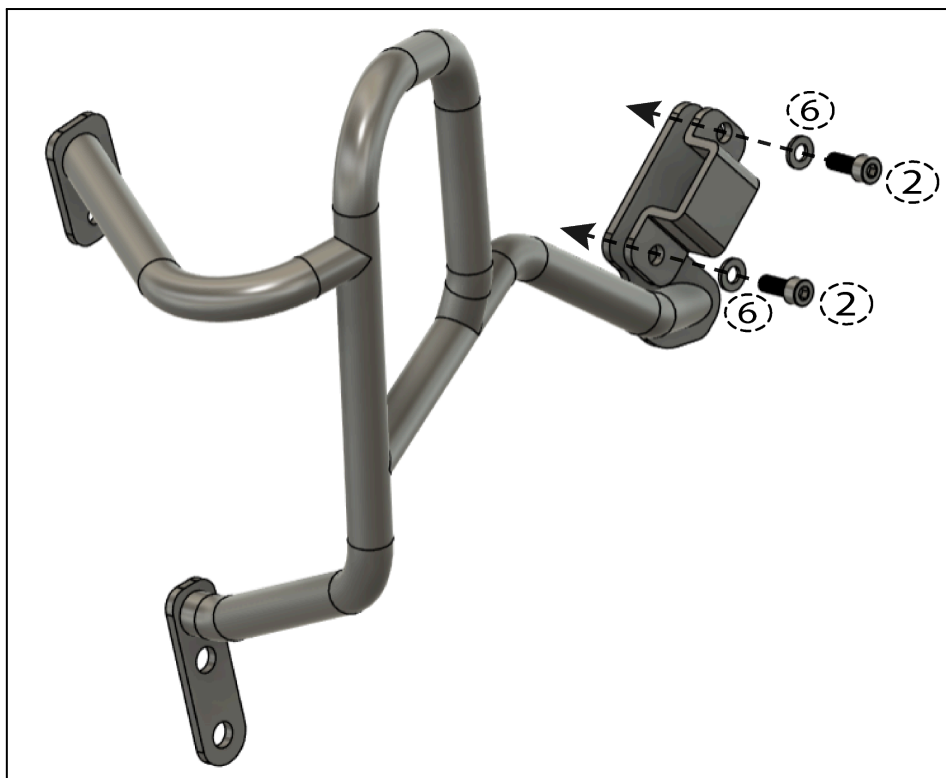

* PLEASE REFER TO THE OWNER'S (OR SERVICE) MANUAL FOR OEM TORQUE SPECIFICATIONS.*

STEP 3:

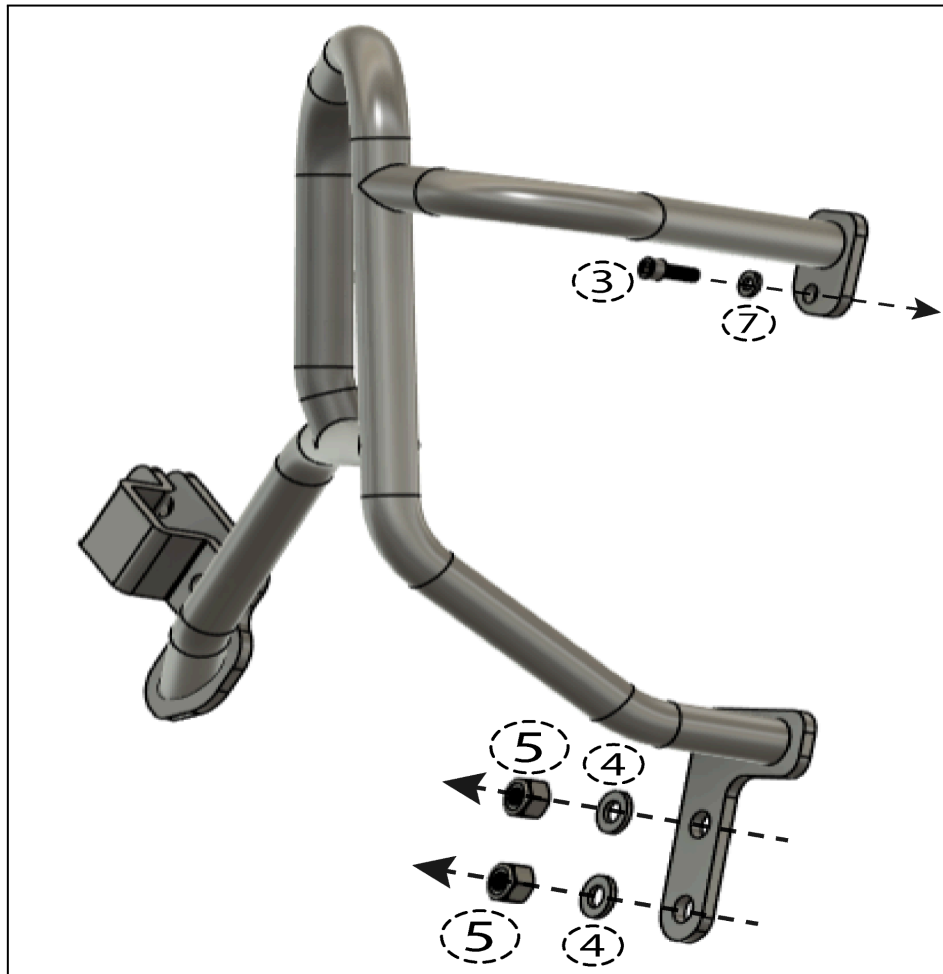

STEP 4:

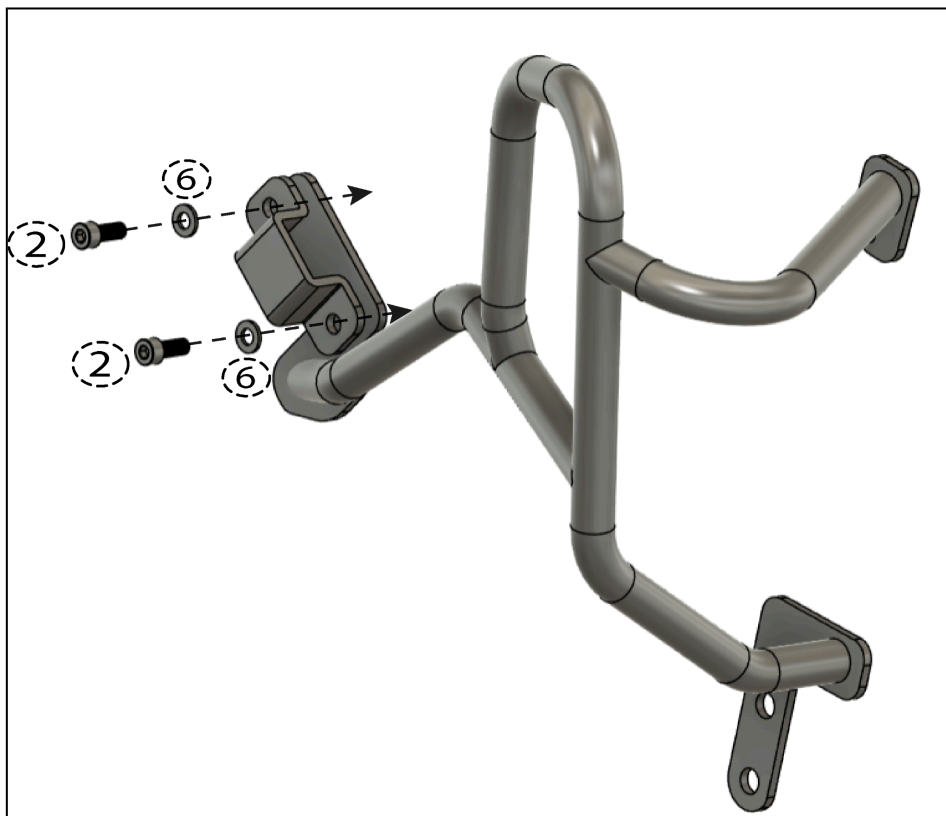

* PLEASE REFER TO THE OWNER'S (OR SERVICE) MANUAL FOR OEM TORQUE SPECIFICATIONS.*