



OUTBACK MOTORCYCLES

Kawasaki KLX 300

QUICK ASSEMBLY GUIDE | **SKID PLATE**

Tools Required

- ☐ 17mm Wrench/Spanner
- ☐ Ratchet + Extension
- ☐ 5mm Allen Socket
- ☐ 6mm Allen Socket
- ☐ 17mm Hex Socket
- ☐ Blue Loctite (recommended)

Number	QTY	Specifications	Torque (NM)
<u>1</u>	2	M10 x 110mm Hex Bolt	*
<u>2</u>	2	M8 x 20mm Allen Bolt	23
<u>3</u>	2	M6 x 20mm Allen Bolt	10
<u>4</u>	4	M10 Washer	-
<u>5</u>	2	M10 Nyloc Nut	-
<u>6</u>	2	M8 Washer	-
<u>7</u>	2	M6 Washer	-

* PLEASE REFER TO THE OWNER'S (OR SERVICE) MANUAL FOR **OEM** TORQUE SPECIFICATIONS.*

STEP 1:

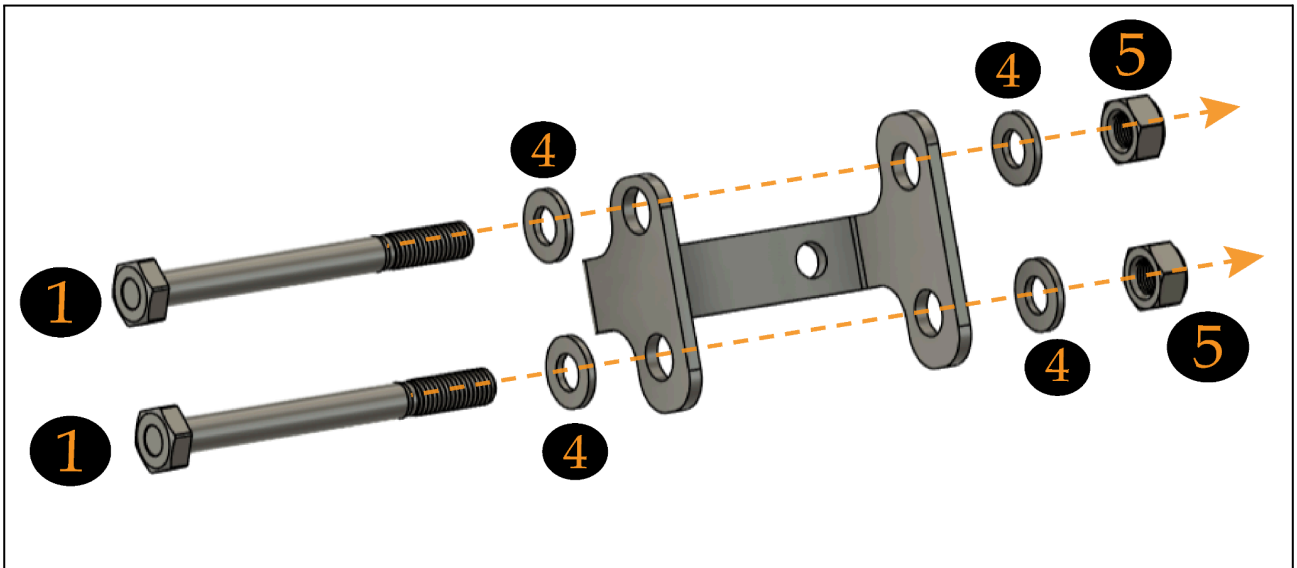

STEP 2:

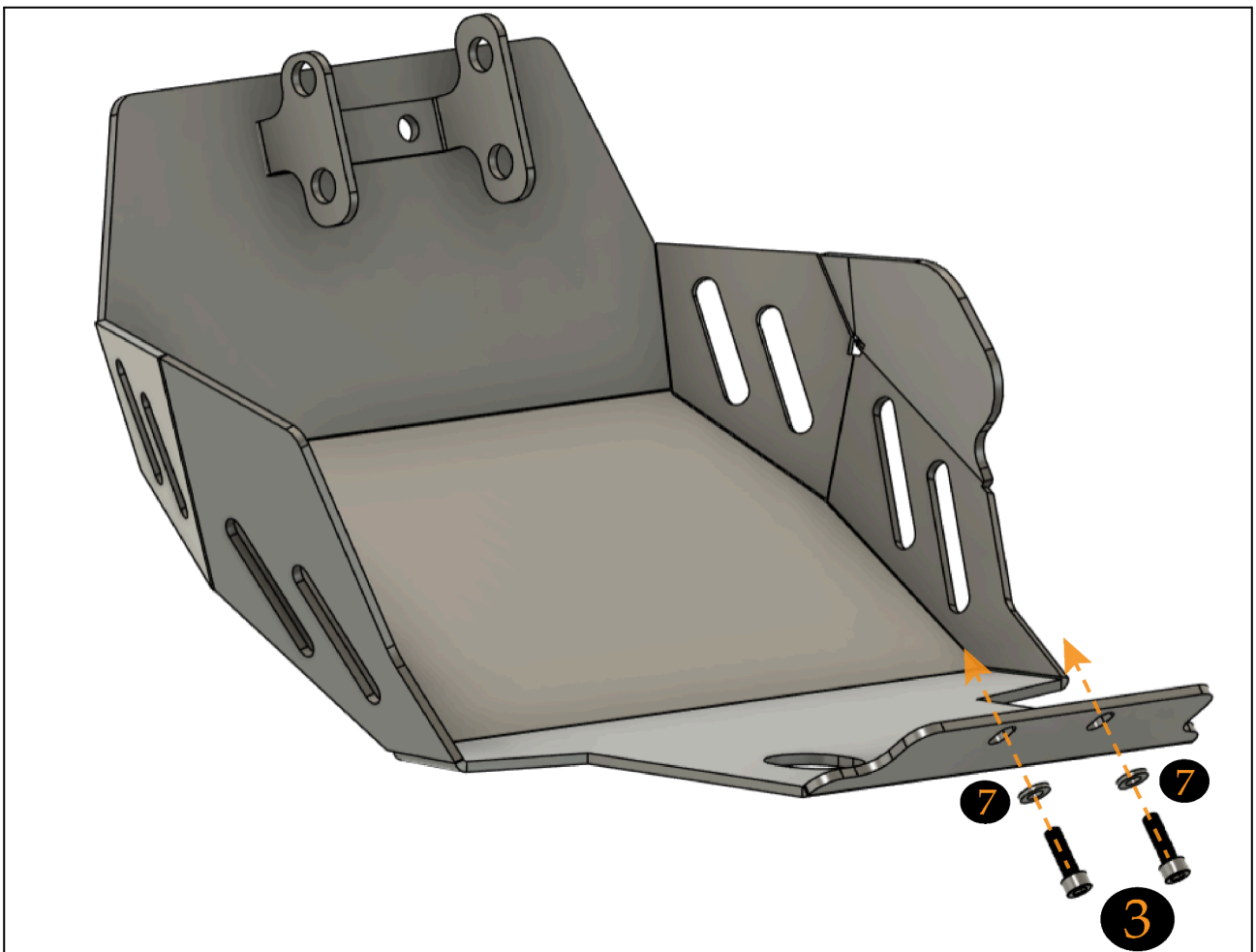

* PLEASE REFER TO THE OWNER'S (OR SERVICE) MANUAL FOR **OEM** TORQUE SPECIFICATIONS.*

STEP 3:

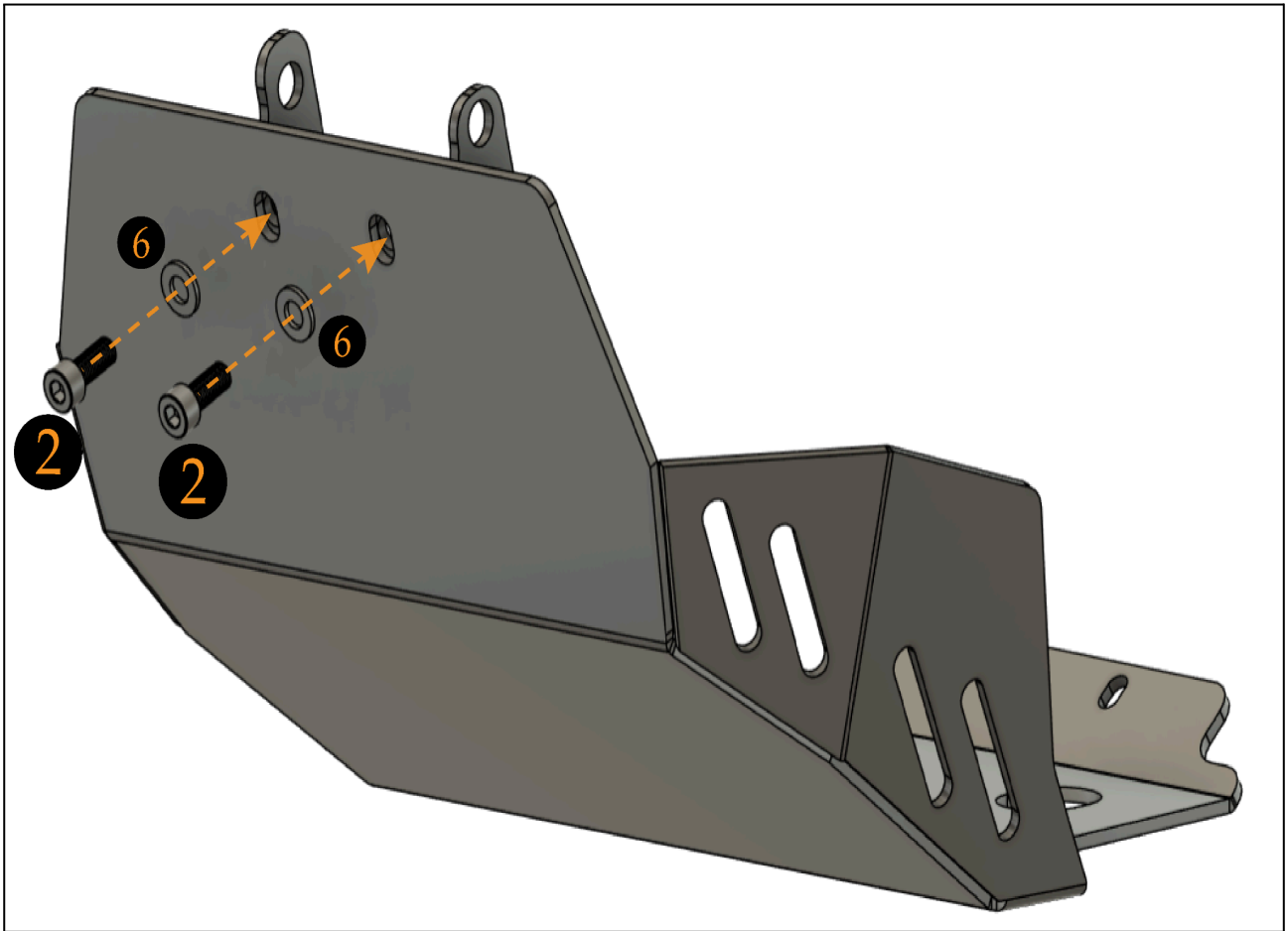

*** Torque Disclaimer ***

Torque specs provided by Outback Motortek are for guidance only and may reference OEM data. Incorrect torque application from miscalibrated or improperly stored torque wrenches (which can drift by up to 20% within 12 months) may cause broken studs or mounting failures. Always return torque wrenches to 0 ft-lbs when storing, and use blue Loctite (medium strength) on all fasteners to help prevent loosening. Outback Motortek is not responsible for damage or failures caused by mis-torquing or improper installation.